

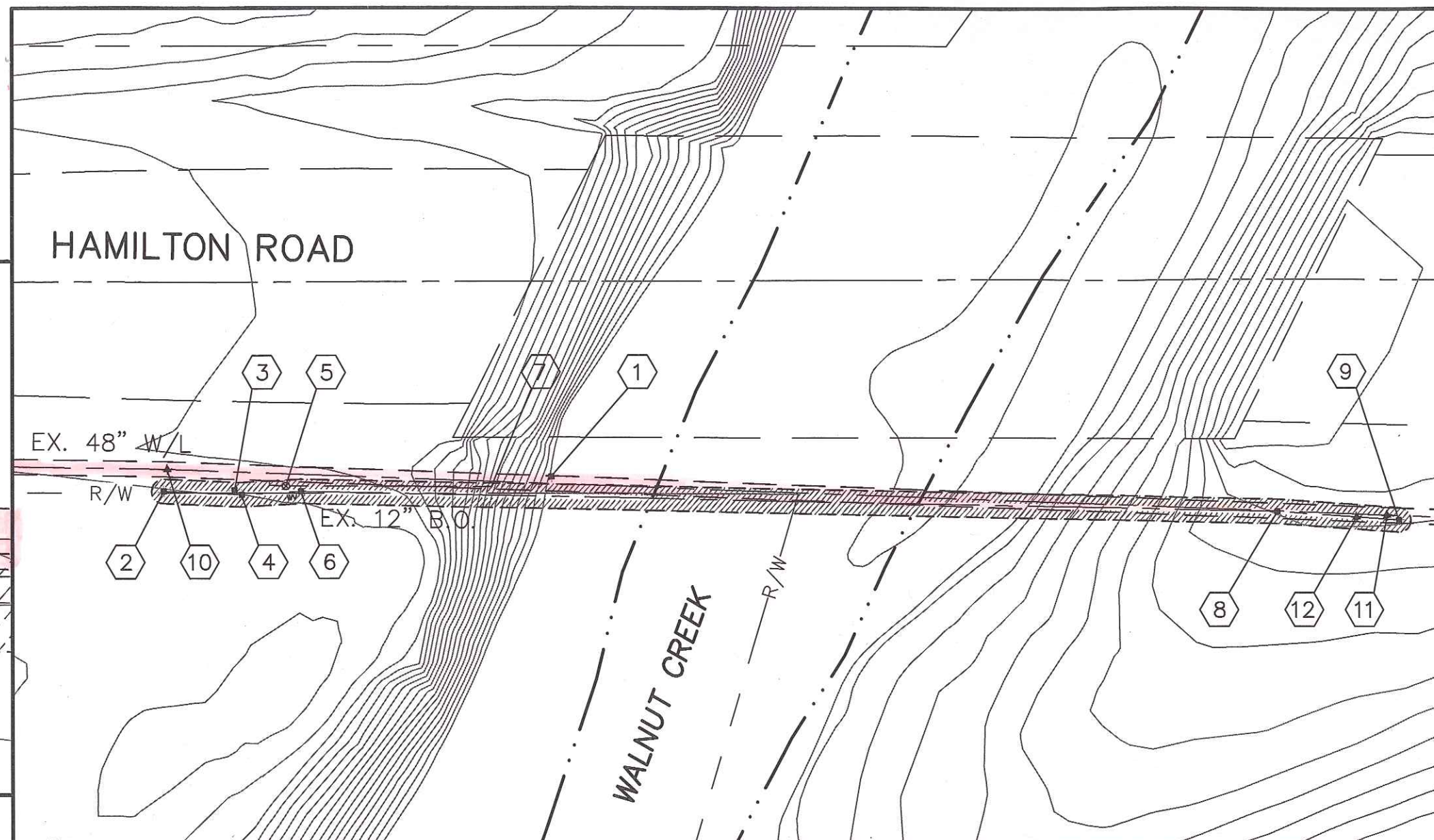

Scale: 1" = 40' (Plan View)

Scale: 1" = 10' (Blow-Up View)

NOVEMBER 2011

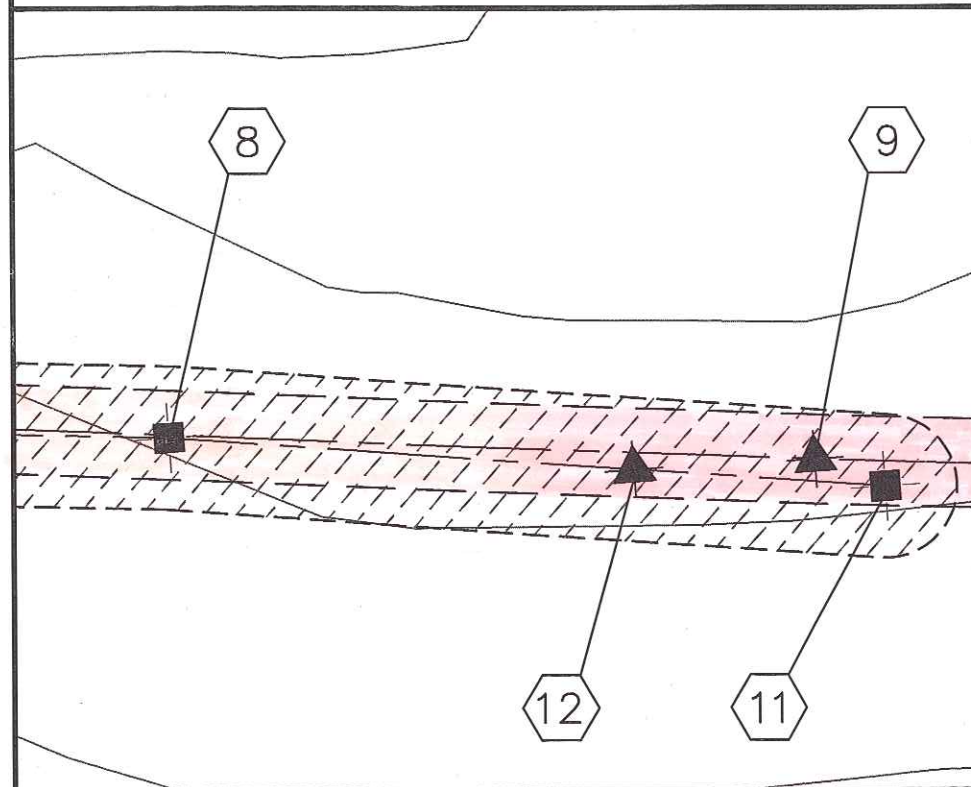
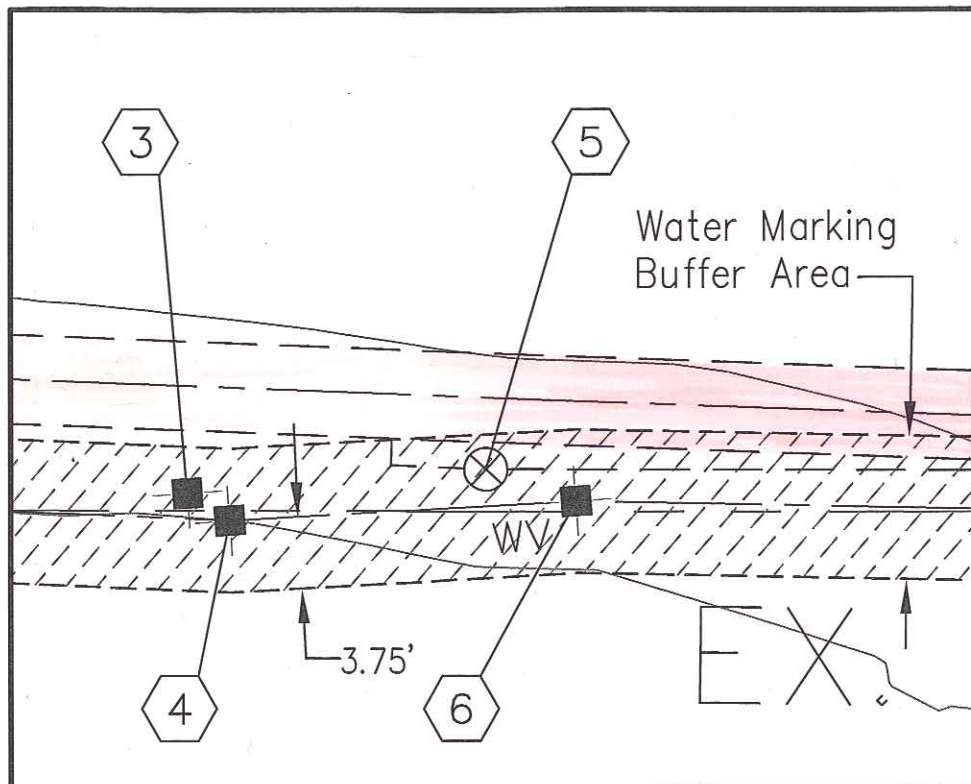

Stantec Survey Points

	Desc	Northing	Easting
1	Leak in W/L (Pnt. #1172) <i>REPAIR</i>	727480.64	1865337.56
2	WAT MKR (Pnt. #1050) <i>Ex</i>	727362.47	1865333.68
3	Exposed Orange Pipe (Pnt. #1060)	727384.14	1865334.81
4	WAT MKR (Pnt. #1059) <i>Ex</i>	727386.26	1865336.39
5	WV (Pnt. #1062) <i>Ex</i>	727399.84	1865334.65
6	WAT MKR (Pnt. #1061) <i>Ex</i>	727404.39	1865336.65
7	12" BLOW OFF PIPE (Pnt. #1074) <i>Ex</i>	727462.05	1865339.31
8	WAT MKR (Pnt. #1148) <i>Ex</i>	727700.59	1865363.88
9	WAT MKR (Pnt. #1147) <i>Ex</i>	727737.68	1865369.07

DOW Survey Points

	Desc	Northing	Easting	
10	Blind Flange S	727363.970	1865326.965	<i>INSTALLED TAPPING SLEEVE</i>
11	Blind Flange N	727734.086	1865367.400	<i>VERTICAL BLIND FLANGE</i>
12	2" Corp./AR <i>Ex</i>	727724.702	1865367.272	<i>INSTALLED TAPPING SLEEVE</i>
	<i>SNOW AIR RELEASE / PITO TAP 11/2014</i>			

LOCATION OF WM (BASED ON ACTUAL LOCATIONS IN FIELD)

WM LOCATION BASED ON MARKS (+3.75' ON EACH SIDE OF MARKS)

CTP 2002
*48" PIPE → 2' RADIUS
3" THICKNESS (ASSUMED)
1.5' MARKING BUFFER
3.75'*

48" W/L @ Hamilton Road & Walnut Creek

TITLE: HAMILTON ROAD 48" WATER MAIN EMERGENCY REPAIRS